

LEGEND

- LIMITED ACCESS HIGHWAY
- STATE ROUTE AND NUMBER
- STATE MAINTAINED BRIDGE ON TOWNSHIP ROAD
- TOWNSHIP ROAD, NUMBER AND SEGMENT LENGTH IN MILES
- IMPASSABLE TOWNSHIP ROAD
- TURNBACK TOWNSHIP ROAD
- OTHER ROAD
- RAILROAD (IN SERVICE)
- RAILROAD ABANDONED (TRACK RETAINED)
- STATE BOUNDARY
- COUNTY BOUNDARY
- TOWNSHIP BOUNDARY
- CITY OR BOROUGH BOUNDARY
- MUNICIPAL BUILDING
- SPLIT MILEAGE BETWEEN MUNICIPALITIES

TOTAL MILES	
Township Road System	66.10*
State Highway System	14.90
Total	81.00

* Includes ACT 32 Turnback Mileage of 6.42

- 348 CRISWELL RD
- 356 LAMMEY RD
- 358 CAMBRIDGE RD
- 364 ASH RD
- 366 BONSALL RD
- 370 CREAMERY RD
- 376 DAVIS RD
- 378 KADLIN RD
- 407 LAKEVIEW DR
- 409 NEAL RD
- 413 SUGARMAN RD
- 415 MARTINS CORNER RD
- 427 COFFROATH RD
- 435 TELEGRAPH RD
- 437 OAK LA
- 439 HILL RD
- 441 LILLY RD
- 443 SANDY HILL RD
- 444 LAFAYETTE RD
- 445 REID RD
- 446 CATON RD
- 447 LEARY RD
- 448 JELKE RD
- 449 BALDWIN RD
- 450 CAINS RD
- 451 PARKESBURG RD
- 452 SKILLES RD
- 453 MOUNT AIRY RD
- 454 AIRPORT RD
- 455 RESERVOIR RD
- 456 MATTSOON HOLLOW RD
- 457 PETRA RD
- 458 BARREN HILLS RD
- 459 RED MILL RD
- 460 BEACON LIGHT RD
- 461 BURKEY RD
- 462 ZALESKI RD
- 463 HILLTOP RD
- 464 MINERAL SPRINGS RD
- 465 ENGLETOWN RD
- 548 MORRIS RD
- 549 RUTLAND AV
- 550 CLEARVIEW DR
- 551 NEVINS WAY
- 552 SKYVIEW DR
- 553 REVERE LA
- 554 BERRY RD
- 555 EVERGREEN DR
- 556 HIGHLAND DR
- 557 VALLEY GREEN DR
- 558 VALLEY GREEN CIR
- 559 SCENIC VIEW DR
- 560 WENDY CIR
- 561 KAREN CIR
- 563 HATFIELD RD
- 564 CAMP STUART RD
- 565 SHELTON DR
- 566 WOODLAND DR
- 567 TAYLORS WAY
- 568 BRIDELL RD
- 569 WAGONTOWN-MARTINS RD
- 570 WATERWORKS RD
- 571 SWEETWATER DR
- 572 RIDGEVIEW DR
- 573 CLYDESDALE CIR
- 574 CHRISTOPHERS LA
- 575 MARIANNA DR
- 576 BRANDYWINE DR
- 577 DEBBIE DR
- 578 PLEASANTWOOD DR
- 579 NORTHWOOD DR
- 580 CEDAR KNOLL RD
- 581 BIRCH RUN DR
- 582 LAKEWOOD DR
- 583 ACORN WAY
- 584 KATHY WAY
- 585 SANDY WAY
- 586 COOPER HAWK DR
- 587 MYSTIC VIEW DR
- 588 LAUREL DR
- 589 WOODLAND DR
- 590 MALLARD DR
- 591 HANSCOM DR
- 592 KYLIES RD
- 593 TYLER DR
- 594 LOCKHARTS LA
- 595 WALSHS WAY
- 596 SHEPHERDS WAY
- 597 COMET LA
- 598 TINA LA
- 599 JANET LA
- 600 TUCKER LA
- 601 JACOBS DR
- 602 TOBY RD
- 603 JOSEPHS WY
- 604 DOMINIC DR

Newlinville 362 CEMI-TC at Compass Rd
 Vegetation start: December 2024
 Construction start: Q1 2025
 Estimated completion: August 2025

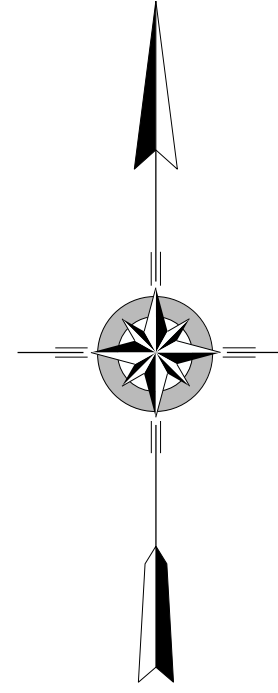
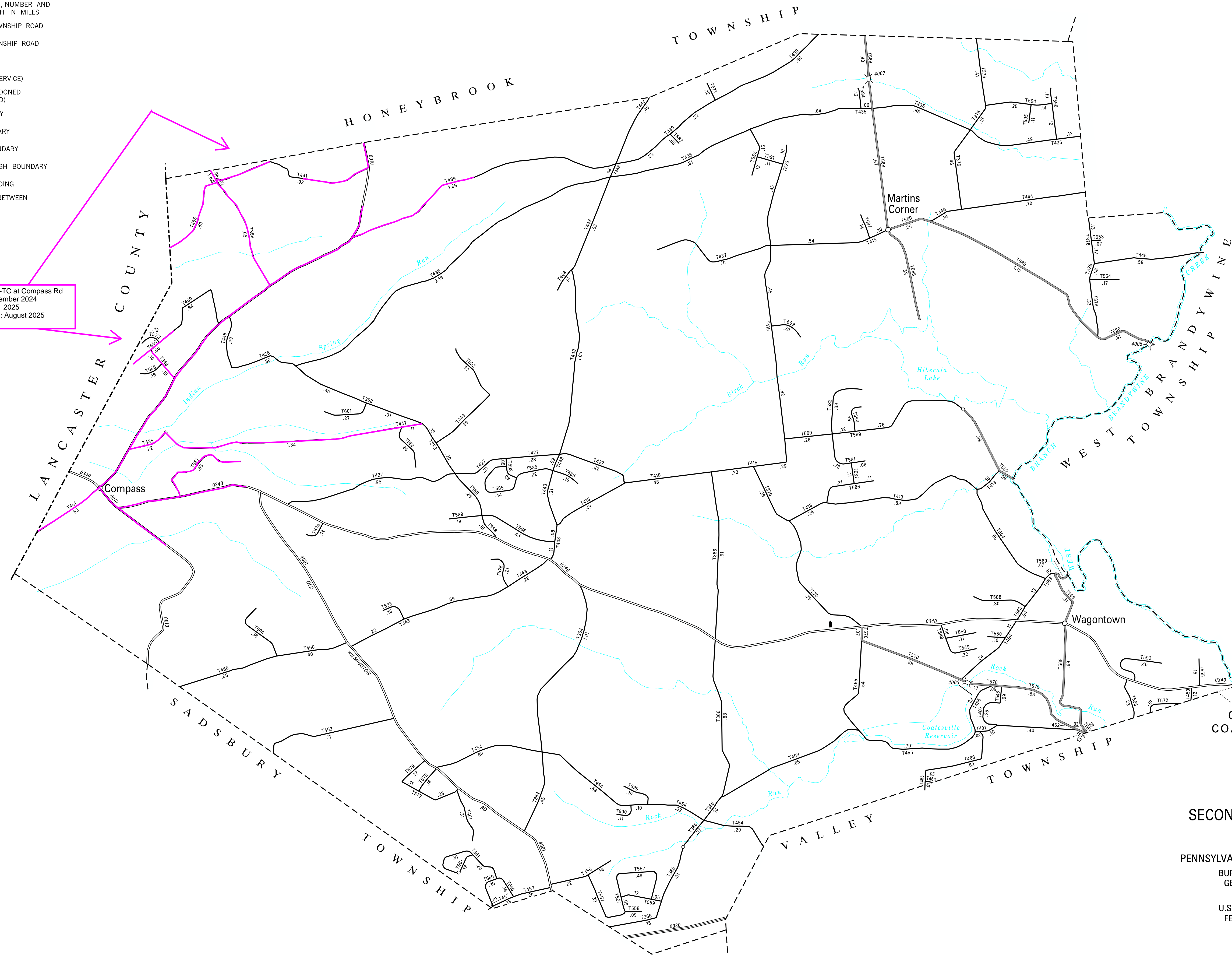

**WEST CALN
 SECOND CLASS TOWNSHIP MAP
 CHESTER COUNTY**

PREPARED BY THE
PENNSYLVANIA DEPARTMENT OF TRANSPORTATION
 BUREAU OF PLANNING AND RESEARCH
 GEOGRAPHIC INFORMATION DIVISION
 IN COOPERATION WITH THE
U.S. DEPARTMENT OF TRANSPORTATION
 FEDERAL HIGHWAY ADMINISTRATION
 MUNICIPAL CODE 15 245
 THIS MAP IS PUBLISHED AS A SUPPLEMENTAL
 DOCUMENTATION OF LIQUID FUELS TAX FUND MILEAGES
 REVISED PER FORM 990 DATED 10-17-19

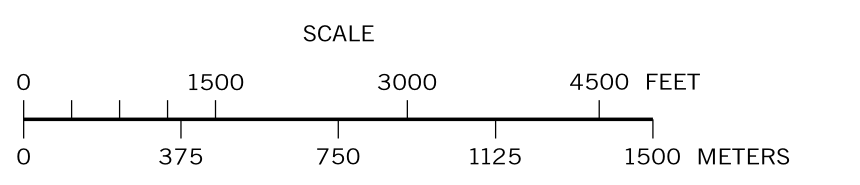

COPIES OF THIS MAP ARE AVAILABLE AT NOMINAL COST
 CONTACT:
 PENNSYLVANIA DEPARTMENT OF TRANSPORTATION
 SALES STORE
 P.O. BOX 3451
 HARRISBURG, PENNSYLVANIA 17105-3451
 TELEPHONE: (717)787-6746